

cecotec

JUICE&LIVE 2500 EASYCLEAN

Licadora de prensa fría / Cold-press juicer



Manual de instrucciones
Instruction manual
Manuel d'instructions
Bedienungsanleitung
Manuale di istruzioni
Manual de instruções

SAFETY INSTRUCTIONS

Read these instructions thoroughly before using the appliance. Keep this instruction manual for future reference or new users. Make sure that the mains voltage matches the voltage stated on the rating label of the appliance and that the wall outlet is grounded.

Check the power cord regularly for visible damage. If the cord is damaged, it must be replaced by the official Technical Support Service of Cecotec in order to avoid any type of danger.

Always turn off and disconnect the appliance from the power supply before assembling, disassembling, cleaning it or if it is not going to be used for a long period of time. Pull from the plug and not the cord to disconnect it.

When pushing ingredients inside the device, use only the accessory provided. Do not use other utensils.

Do not introduce hot ingredients above 60 °C to avoid malfunction.

Do not introduce any utensil or body parts inside the product during operation in order to reduce risk of injuries to persons or damage to the product.

Do not touch or operate the device with wet hands.

Do not repair or remove any fixed part of the product. Contact the Technical Support Service of Cecotec for help or advice.

Always make sure all the detachable parts are properly placed and fixed before operating it. If any of the parts is damaged, do not use it.

After using the device, make sure to turn off and disconnect the product from the power supply.

Do not place the device close to heat sources, flammable or explosive substances.

Slowly introduce the fruit pieces to ensure no damage occurs to the product.

Do not use fruits or vegetables with bone, pips, solid shell or thick skin. Remove any of these before introducing them in the product.

This device is not suitable for juicing sugarcane, ginger, cress (small celery) and other food with much fibre. We recommend to cut the fruit into small pieces before juicing them, or it may cause stunk and damage of components, which will affect the appliance's life.

If the machine overloads or blocks during operation, it will stop automatically. After a few seconds, the device will beep indicating it can be used again.

The machine may automatically stop working after 15 minutes of continuous operation to avoid overheating and damages in the motor. If this happens, allow the device to rest for 20–30 minutes before using it again.

It can be used by children over the age of 8, as long as they are given continuous supervision.

This appliance can be used by children aged 8 and above, and persons with reduced physical, sensory or mental capabilities or lack of experience and knowledge, as long as they have been given supervision or instruction concerning the use of the appliance in a safe way and understand the hazards involved. Supervise young children to make sure that they do not play with the appliance. Close supervision is necessary when the appliance is being used by or near children.

Note: This product has undergone a quality control previous to its commercialization with the aim of ensuring its correct operating. After the quality control testing, the appliance is cleaned thoroughly, therefore, although it is unlikely to occur, there could be rests of water drops in its inner parts.

Make sure the device's parts are correctly assembled. During operation, make sure the machine is on a stable surface.

Do not move the device while it is operating.

Do not cover the inlet or outlet of the device as it may cause a blockage and damage the device.

Do not use any metal brush, sharp tool or any kind of abrasive material for cleaning the device.

Do not clean or immerse the device in water. Use a damp cloth to wipe any stain.

Do not use the device for more than 15 minutes in a row.

Turn the device off when it is not being used.

Do not clean the device under water hotter than 60 °C.

If the screw conveyor gets jammed while the device is operating and the device stops working, press the REV button for 3-5 seconds to reverse the screw conveyor's rotation, then press the power button again.

1. PARTS AND COMPONENTS

Fig. 1

1. Fig. 2
2. Pusher
3. Top dosing lid
4. Screw conveyor
5. Filter
6. Juice jar
7. Residue jar
8. Juice tank
9. Main body (Motor)
10. Cleaning brush

2. BEFORE USE

Take the product out of the box and remove all packaging materials.

Make sure all parts and accessories are present and in good conditions. If not, contact immediately the Technical Support Service of Cecotec.

Clean thoroughly all the product's parts that come into contact with ingredients before operating it for the first time.

3. PRODUCT ASSEMBLY

1. Assemble the juice tank in the main body.
2. Place the filter inside the juice tank, making the arrow on the filter point at the juice tank's arrow. Then, assemble the screw conveyor firmly inside the filter.
3. Assemble the pusher into the top dosing lid, then install the top dosing lid on the juice tank. Fasten the top cover to the Lock mark to hold it firmly in place.

Fig. 3

Removing the rubber footing:

Fig. 4

Note: The juice tank is equipped with a rubber footing. Make sure the rubber footing is connected to the juice tank before operating the device. Remove the rubber footing before cleaning the device.

4. OPERATION

1. Operate the device with fresh fruit inside, in order to get a higher level of water content.
2. Rinse and cut the fruit in size that fit into the dosing tube.
3. Remove the fruit's core and seeds.
4. Place foodstuff inside the dosing tube and slightly press it down using the pusher.

If the device stops juicing:

1. Allow it to cool down if you used it for more than 15 minutes.
2. Keep the REV button pressed for 2-5 seconds to push the fruit upwards, then press the power button and resume the juicing.

Notes:

Do not force the fruits into the device to prevent damage in the screw conveyor and filter.

Do not juice cereals or sugar cane.

Do not juice for more than 15 minutes in a row.

5. CLEANING AND MAINTENANCE

This device includes a plastic juice tank and filter, which are very easy to clean. Unplug the device and allow it to cool down before cleaning it.

Turn the dosing lid to the Unlock mark and remove it.

Disassemble the device's parts by pulling the juice tank up. Remove and wash the screw conveyor and filter.

Disconnect the appliance from the power supply and allow it to cool down before cleaning.

Use a soft, damp cloth to clean the product's surface.

Do not immerse the appliance in water or other liquid.

Do not use abrasive scouring pads, powders or cleaners.

The lid, pusher, screw, filter, jars and tank are dishwasher-safe.

6. TROUBLESHOOTING

Problem	Solution
The appliance does not start operating.	Check if the device is properly plugged to an outlet. Check that all the device's parts are correctly assembled.

Not much juice comes out	Make sure rubber footing at the bottom of the juice tank is attached firmly to it. Fresh fruits provide the highest level of juice output.
The device stops operating suddenly	Check if there is too much food inside the device. Check if some foodstuff may be causing the blockage. Press the REV button for 3 to 5 seconds and then the power button. If the device still does not work after this, turn it off and wait for 15 minutes before turning it on again.
The device emits a sound while operating and vibrates	This is perfectly normal. Hard ingredients such as carrots, potatoes, beetroots, radish, etc. may cause the appliance to emit louder sounds than soft ingredients.

7. TECHNICAL SPECIFICATIONS

Product reference: 04276

Product: Juice&Live 2500 EasyClean

Rated voltage: 220-240 V~

Frequency: 50-60Hz

Rated power: 200 W

8. DISPOSAL OF OLD ELECTRICAL APPLIANCES



The European directive 2012/19/EU on Waste Electrical and Electronic Equipment (WEEE), specifies that old household electrical appliances must not be disposed of with the normal unsorted municipal waste. Old appliances must be collected separately, in order to optimize the recovery and recycling of the materials they contain and reduce the impact on human health and the environment.

The crossed out "wheeled bin" symbol on the product reminds you of your obligation to dispose of the appliance correctly. If the product has a built-in battery or uses batteries, they should be removed from the appliance and disposed of appropriately.

Consumers must contact their local authorities or retailer for information concerning the correct disposal of old appliances and/or their batteries.

9. TECHNICAL SUPPORT SERVICE AND WARRANTY

This product is under warranty for 2 years from the date of purchase, as long as the proof of purchase is submitted, the product is in perfect physical condition, and it has been given proper use, as explained in this instruction manual.

The warranty will not cover the following situations:

The product has been used for purposes other than those intended for it, misused, beaten, exposed to moisture, immersed in liquid or corrosive substances, as well as any other fault attributable to the customer.

The product has been disassembled, modified, or repaired by persons, not authorised by the official Technical Support Service of Cecotec.

Faults deriving from the normal wear and tear of its parts, due to use.

The warranty service covers every manufacturing defects of your appliance for 2 years, based on current legislation, except consumable parts. In the event of misuse, the warranty will not apply.

If at any moment you detect any problem with your product or have any doubt, do not hesitate to contact Cecotec Technical Support Service at +34 963 210 728.

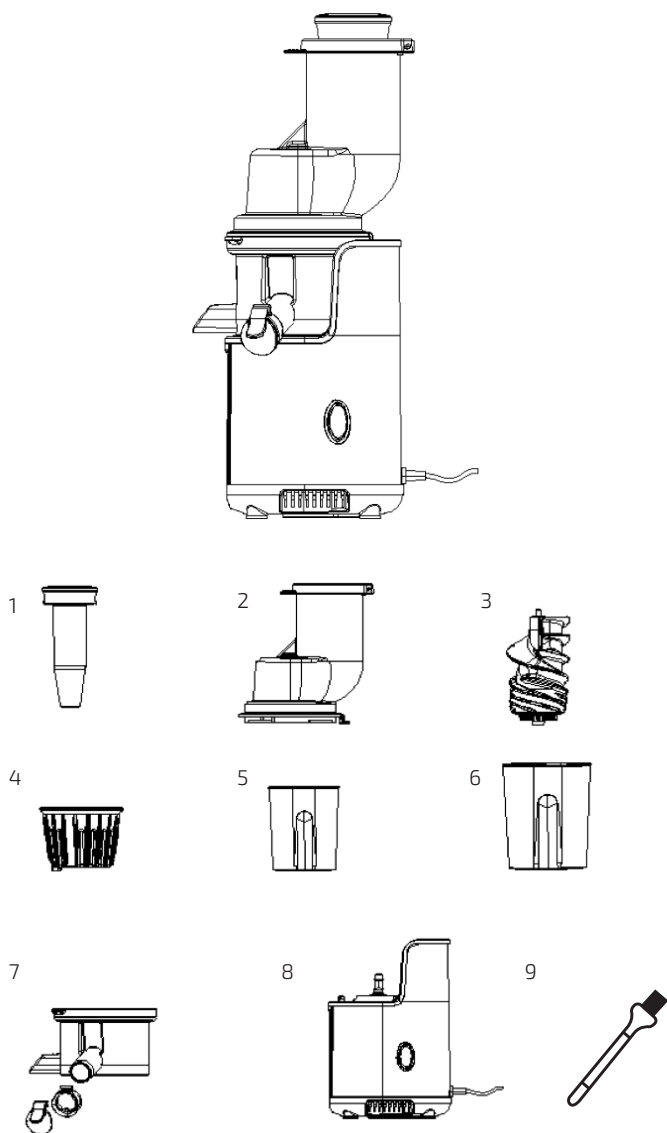

Fig./Img./Abb. 1

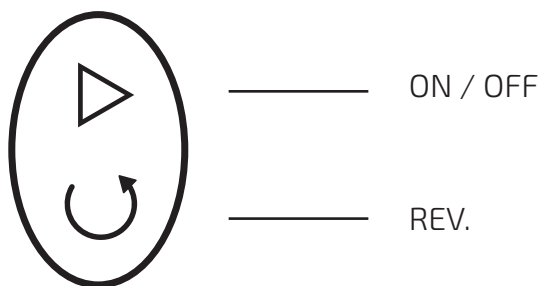

Fig./Img./Abb. 2

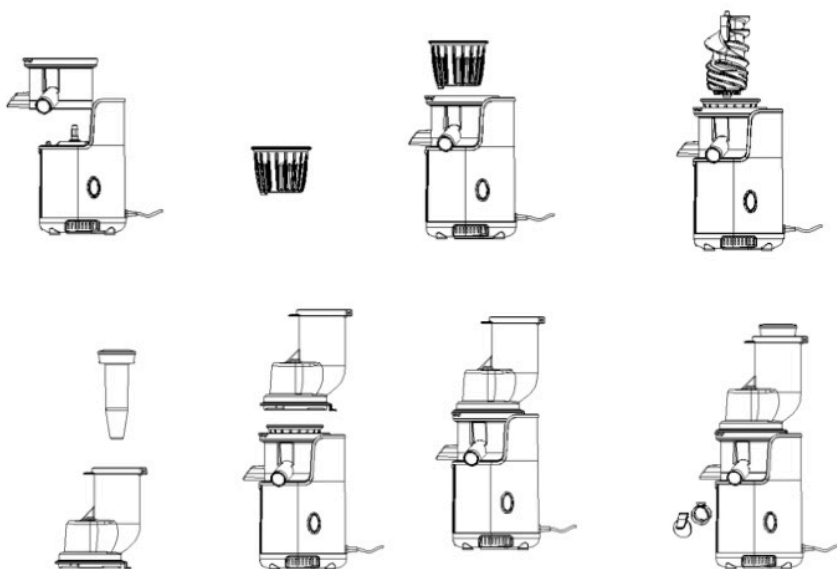

Fig./Img./Abb. 3

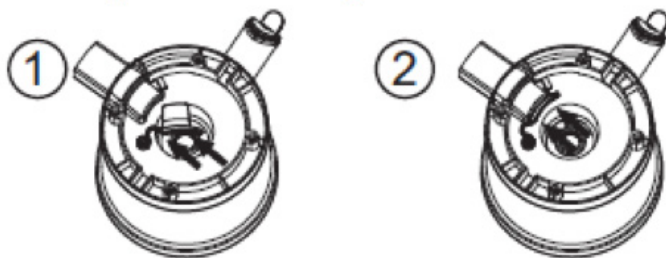

Fig./Img./Abb. 4

www.cecotec.es

Grupo Cecotec Innovaciones S.L.
C/ de la Pinadeta s/n, 46930
Quart de Poblet, Valencia (Spain)

YV01200402